

## Seattle Art Museum

# Museum Map

Welcome! Get inspired and connected with art from around the world that bridges cultures and centuries.

All entrances are ADA accessible. Wheelchairs are available for loan at Coat Check.

Smart devices available for loan at Coat Check.

## Ground Floor

- Elevator
- Escalator
- Stairs
- Emergency Exit
- Restrooms
- All-Gender Restroom
- Closed

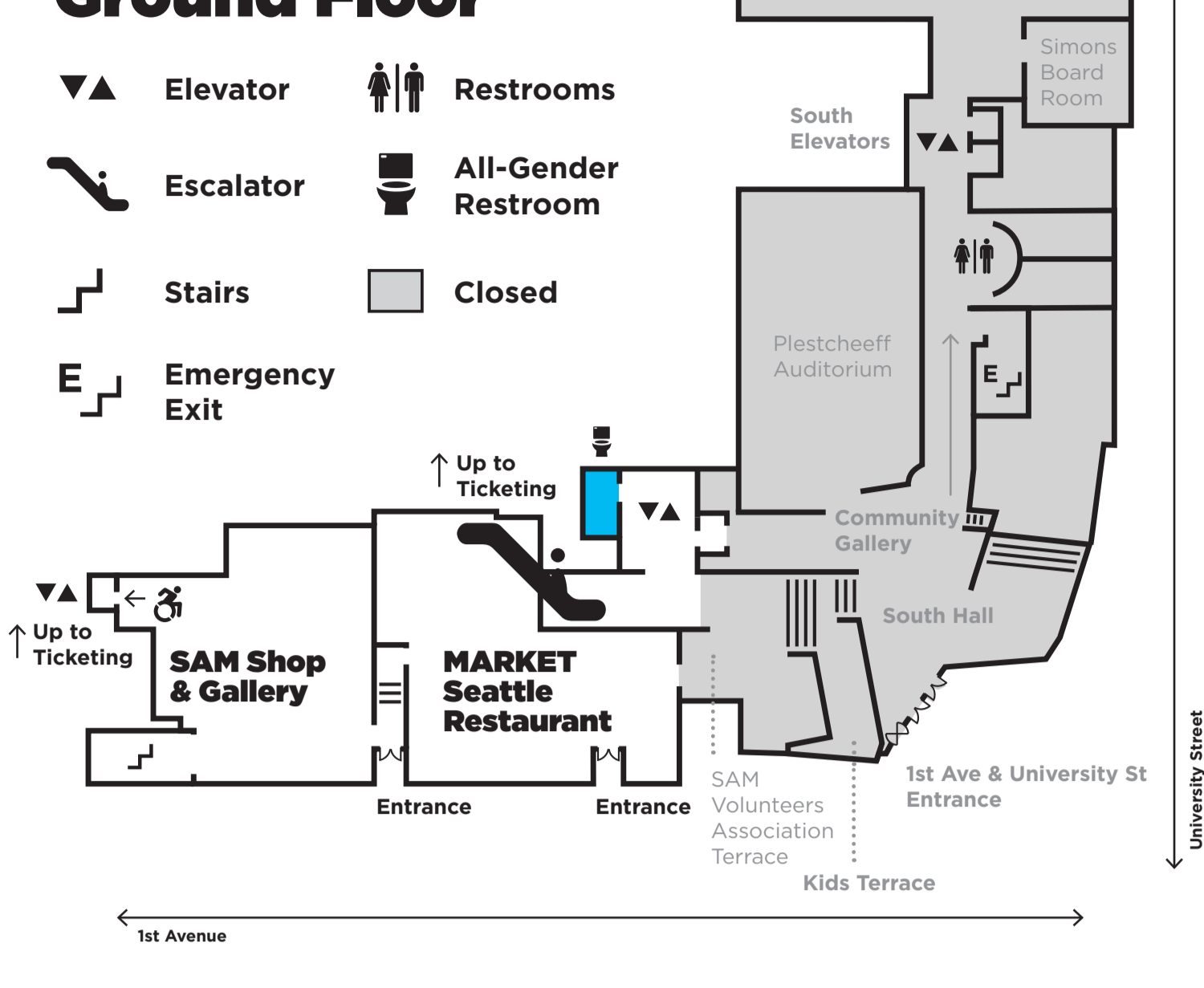

## Second Floor

- Restrooms
- Information
- Ticketing
- Elevator
- Escalator
- Stairs
- Emergency Exit
- Closed

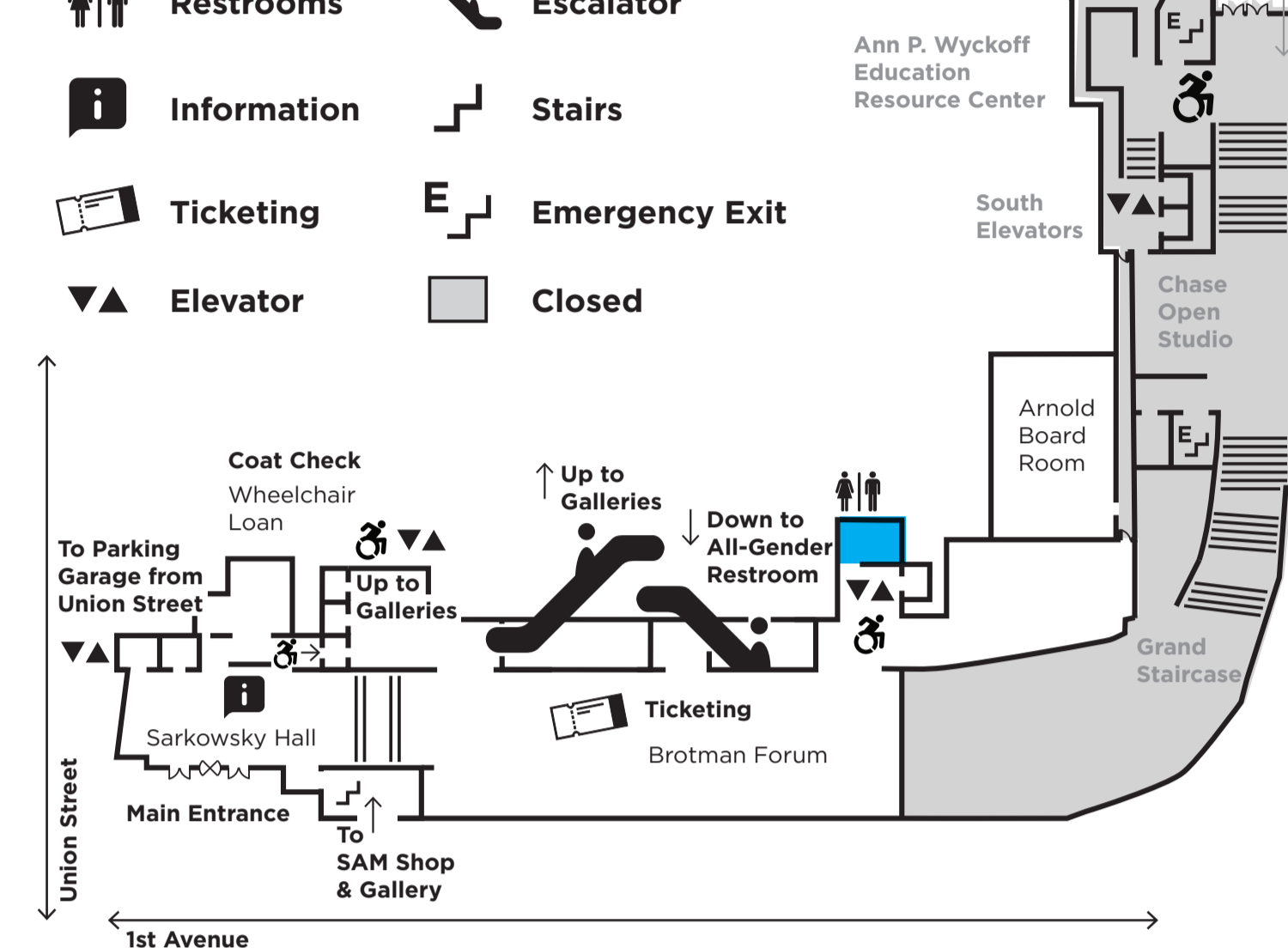

## Smartphone Tour

Smartphone tours are available on your own device for free! Select a thematic tour or look for the phone symbol/QR code next to selected artworks and enter the number to access multimedia content and interesting perspectives.

[visitsam.org/explore](https://visitsam.org/explore)

## Third Floor

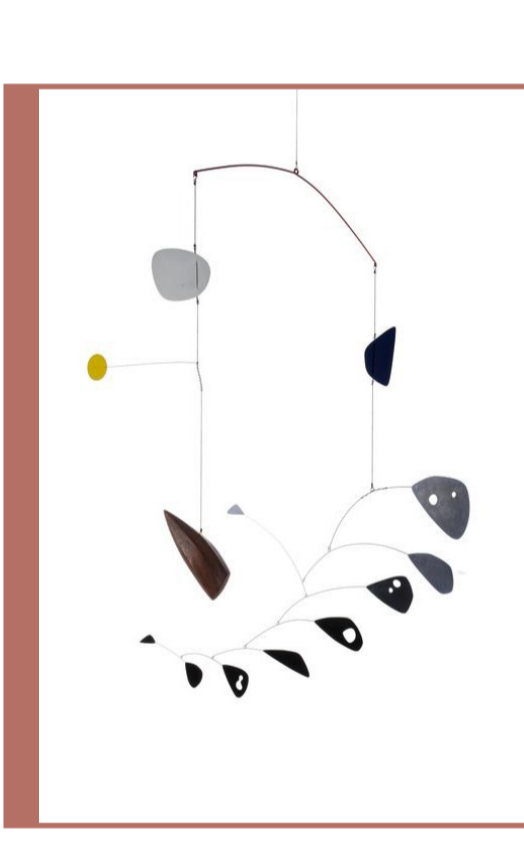
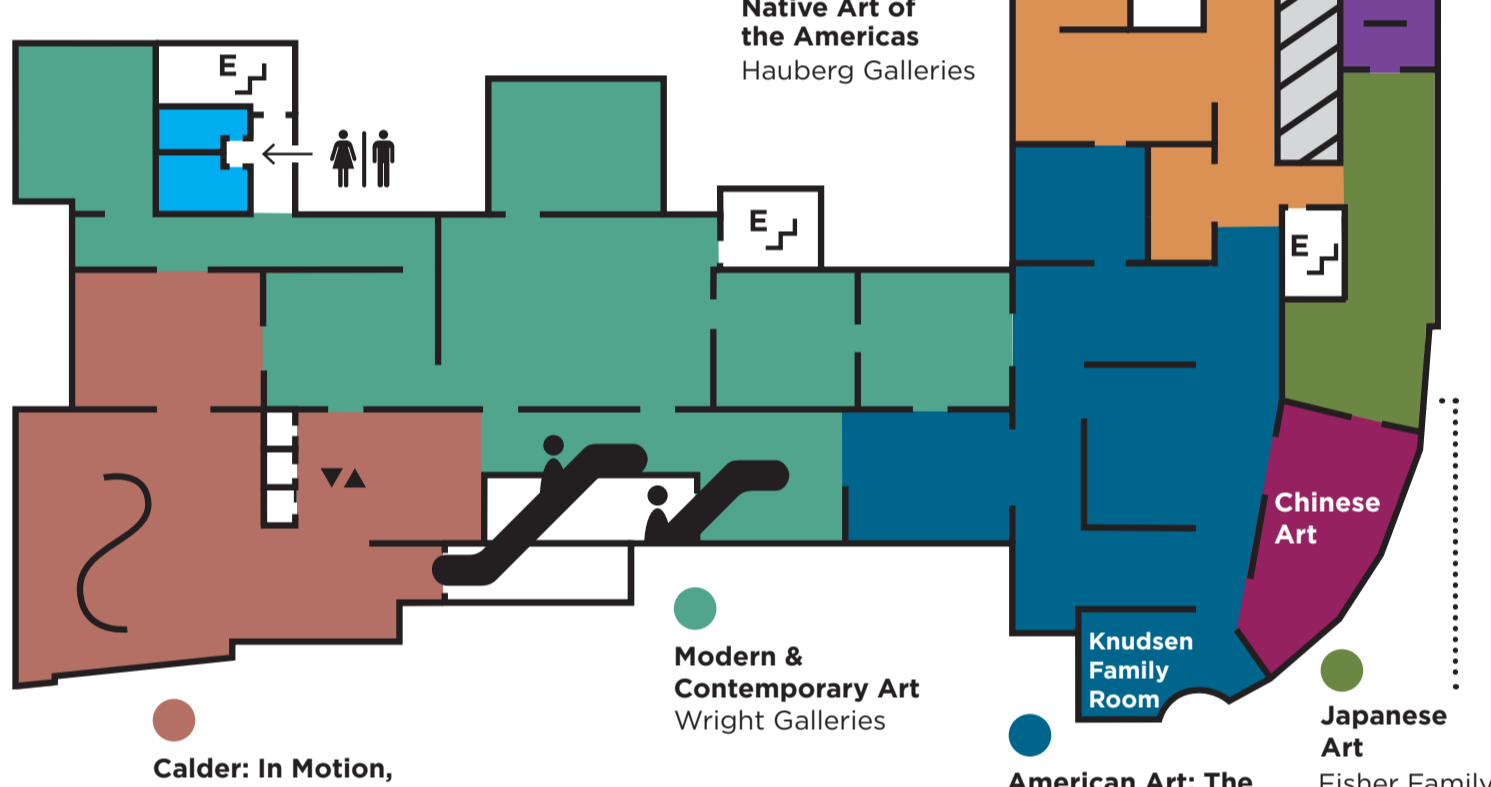

**Calder: In Motion, The Shirley Family Collection**  
Through Aug 4 2024

Discover the iconic artist Alexander Calder, celebrated for revolutionizing sculpture with his renowned mobiles and stabiles. This is a rare opportunity to see the entire collection of over 45 works, plus lithographs and related ephemera, gifted to the museum by Jon and Kim Shirley.

*Untitled*, 1948, Alexander Calder



**American Art: The Stories We Carry**  
Ongoing

Explore a more expansive vision of American art, with artworks from the museum's historical American collection presented in dynamic conversation with Native, Asian American, African American, and Latinx art.

*Northwest Salmon Fishermen*, 1941, Rudolph Franz Zallinger

## Fourth Floor

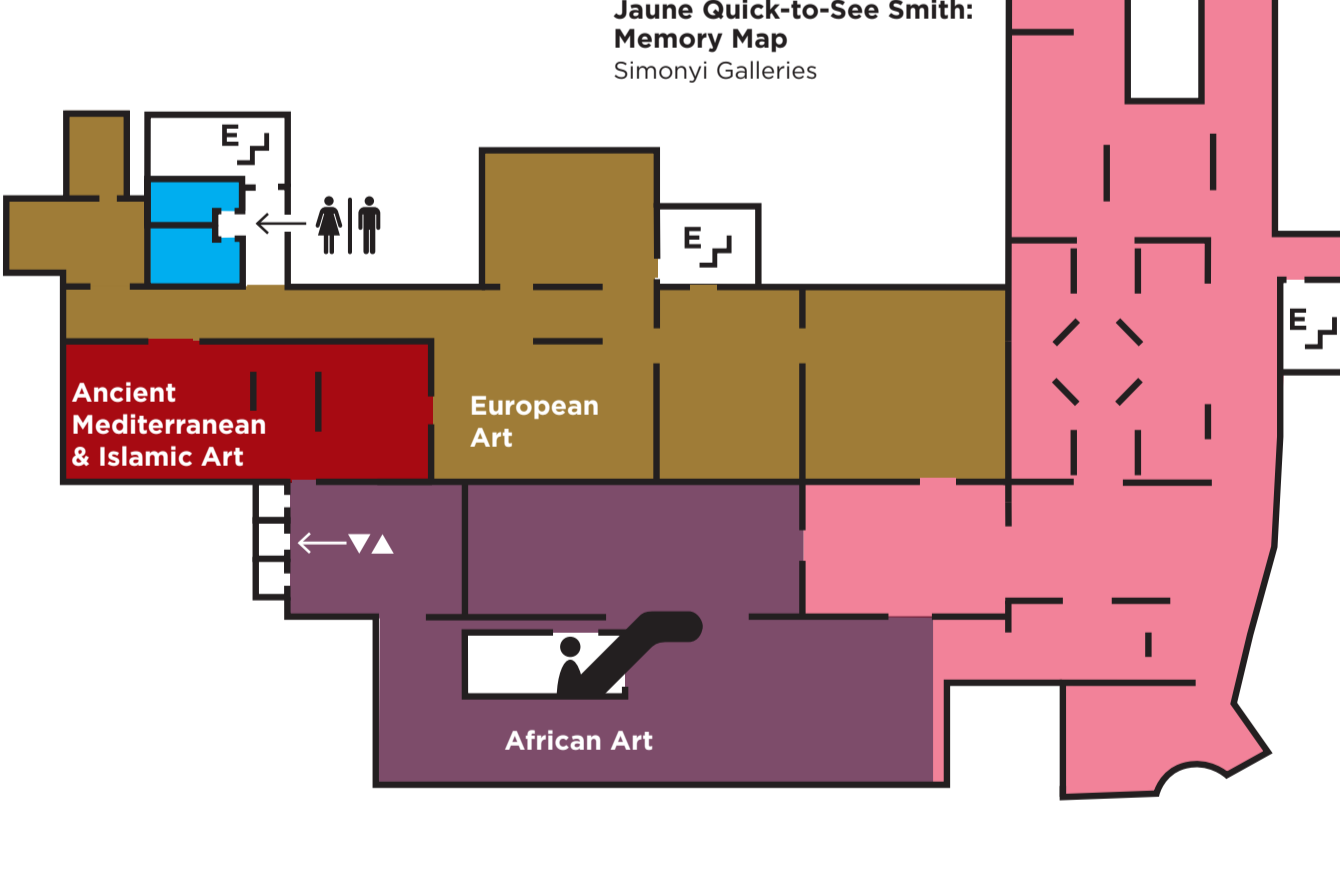

**Jaune Quick-to-See Smith: Memory Map**  
Through May 12, 2024

One of the most innovative artists of her generation, Jaune Quick-to-See Smith has forged new paths for contemporary art by interrogating American identity from a Native American perspective. Explore five decades of her barrier-breaking artwork in her largest and most comprehensive retrospective to date.

*McFlag*, 1996, Jaune Quick-to-See Smith

## Turn your ticket into a membership today!

Become a SAM member and enjoy unlimited free admission all year. Visit the Ticketing Desk or give us a call at 206.654.3210 to apply your ticket towards a membership today!

Seattle Art Museum respectfully acknowledges that we are on Indigenous land, the traditional territories of the Coast Salish people. We honor our ongoing connection to these communities past, present, and future.

**Images:** *Untitled*, ca. 1948, Alexander Calder, 1898-1976, sheet metal, wire, wood, string, and paint, 52 x 95 x 3 in., Promised gift of Jon and Mary Shirley, © 2024 Calder Foundation, New York / Artists Rights Society (ARS), New York, photo: Nicholas Shirley, Brightwood Photos. *Northwest Salmon Fishermen*, 1941, Rudolph Franz Zallinger, tempera on pressed fiber board, in artist-made engaged frame, 25 3/4 x 35 5/8 in., in artist made engaged frame, 27 7/8 x 37 7/8 in., Eugene Fuller Memorial Collection, 43.34, © Rudolph F. Zallinger. Image courtesy of the artist. *McFlag*, 1996, Jaune Quick-to-See Smith, oil, paper, and newspaper on canvas with speakers and electrical cord, three parts: 60 x 100 in. overall, Tia Collection. Fabricated by Neal Ambrose-Smith, © Jaune Quick-to-See Smith, Photograph courtesy the artist and Garth Greenan Gallery, New York