

Seattle Asian Art Museum

Map & Guide

Welcome to Seattle Asian Art Museum! This 1933 Art Deco building in lush Volunteer Park is SAM's original home and the location of our extensive Asian art collection, making it one of the most beloved treasures in our creative, cultured, and curious city.

Entrances are ADA accessible.

Gallery Level

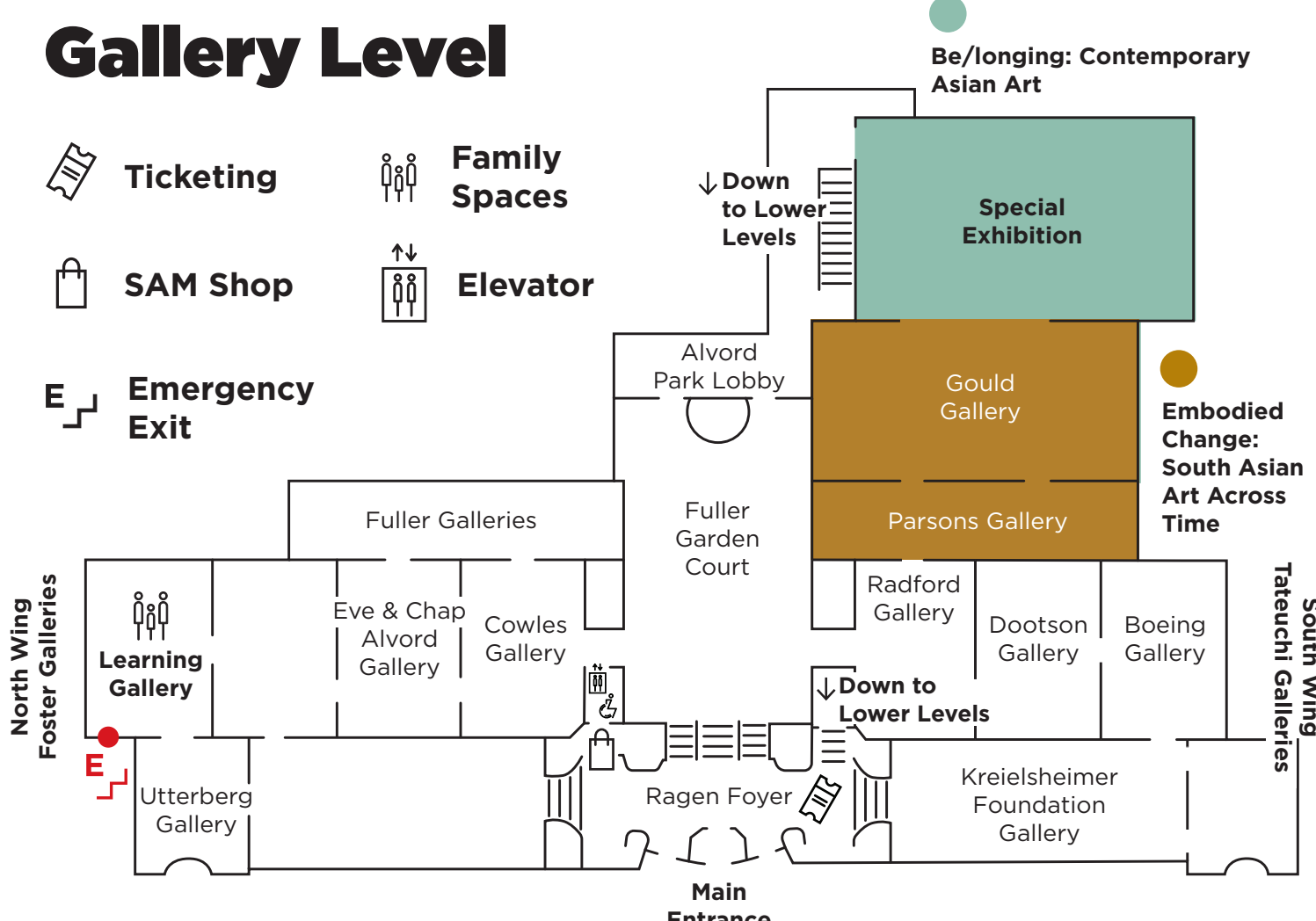

Embodied Change: South Asian Art Across Time

Through July 10, 2022

Spanning a period from the third millennium BCE to today, the works in this exhibition offer metamorphic and compelling images of the human body. Most of the artists utilize female and feminized forms in a myriad of ways, including as a devotional object, as a mode of self-representation, and to question the safety of public spaces.



Be/longing: Contemporary Asian Art Ongoing

Born across Iran, India, Azerbaijan, Thailand, China, Korea, and Japan, the 12 contemporary artists in this exhibition explore their Asian heritage from differing perspectives. Shown together, these artworks aim to answer fundamental questions of who we are and where we belong.

Smartphone Tour

Access our free smartphone tours from your own device! Select a thematic tour or look for the phone symbol/QR code next to selected artworks and enter the number to find additional content and discover new perspectives.

中文版精品导览 visitsam.org/explore

Lower Level

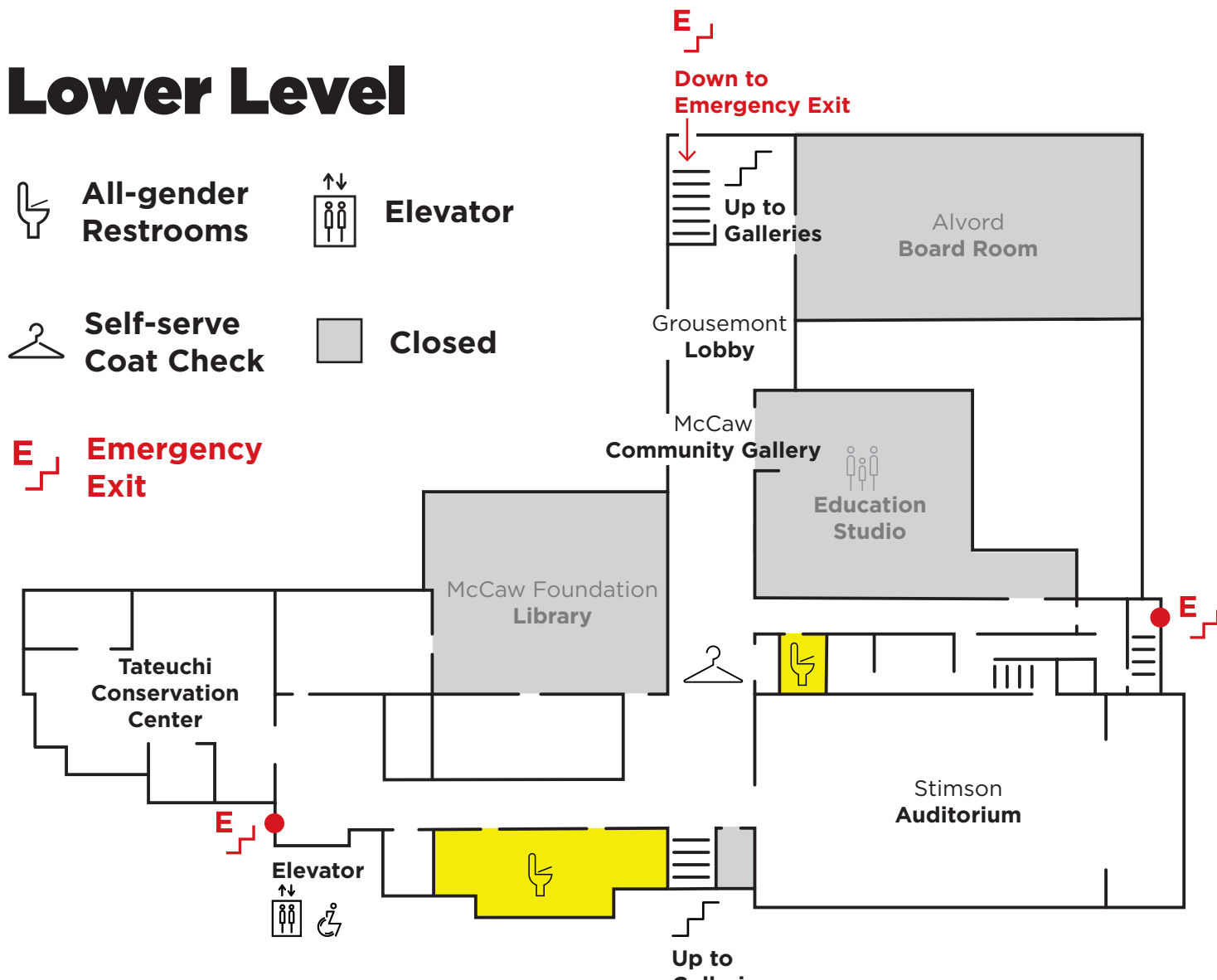

Turn your ticket into a membership today!

Become a member and enjoy unlimited free admission for 12 months to all SAM locations, including special exhibitions. Visit the ticketing desk to apply your ticket toward a membership today!

Seattle Art Museum respectfully acknowledges that we are on Indigenous land, the traditional territories of the Coast Salish people. We honor our ongoing connection to these communities past, present, and future.

Images: *Miss Macho (Self Portrait)*, from the False Friends series, 2007, Mithu Sen, Indian, born 1971, mixed media photocollage on archival paper, Collection of Sanjay Parthasarathy. *Some/One*, 2001, Do Ho Suh, Korean, born 1962, stainless steel military dog-tags, nickel-plated copper sheets, steel structure, glass fiber reinforced resin, rubber sheets, diameter at base: 24 ft. 4 in., Height: 81 in., Gift of Barney A. Ebsworth, 2002.43, © Do Ho Suh, photo: Adam Hunter/LMN Architects.