

Seattle Art Museum

Museum Map

Welcome! Get inspired and connected with art from around the world that bridges cultures and centuries.

All entrances are ADA accessible. Wheelchairs are available for loan at Coat Check.

Smart devices available for loan at Coat Check

Ground Floor

- Elevator
- Escalator
- Stairs
- Emergency Exit
- Restrooms
- All-Gender Restroom
- Closed

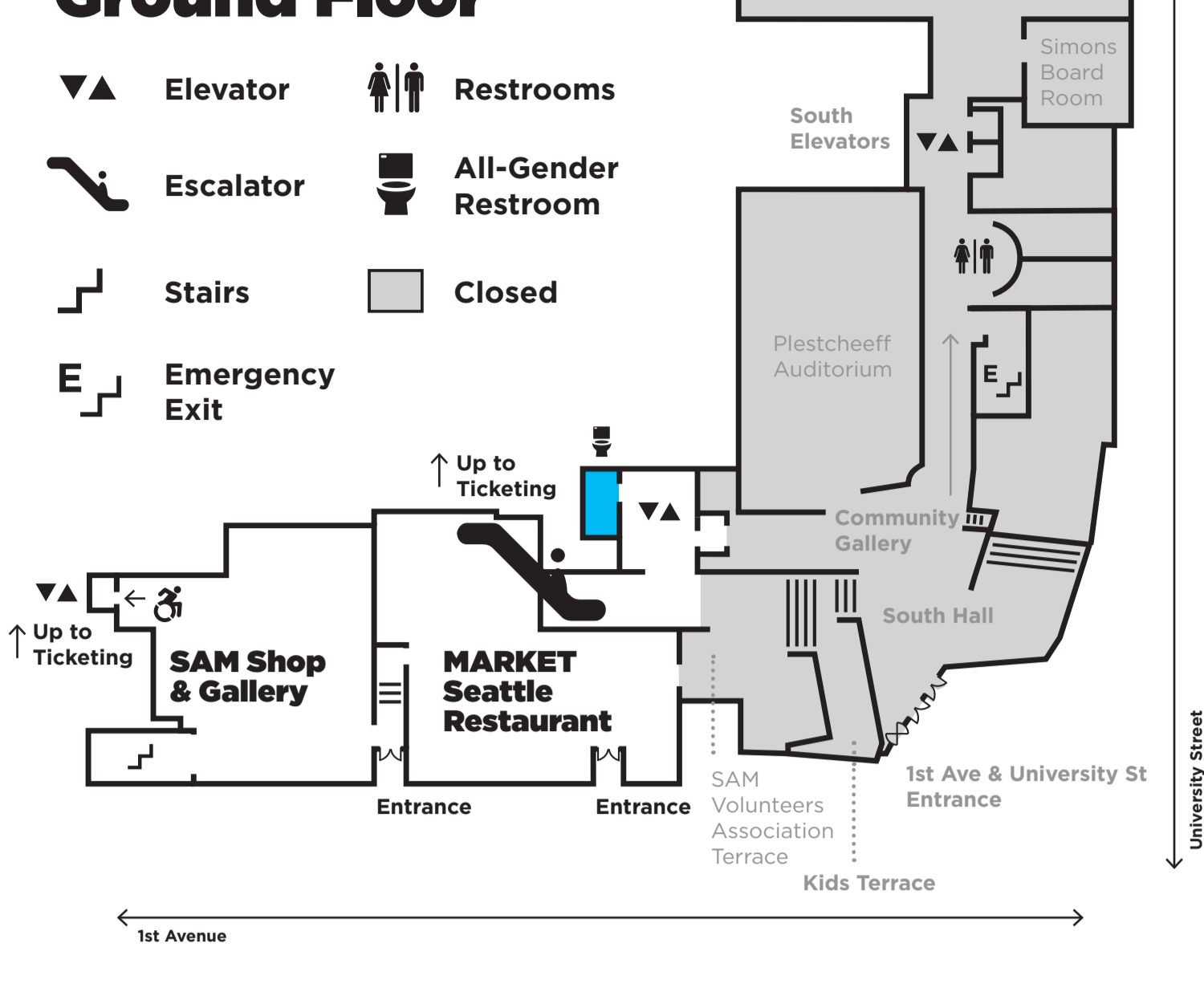

Second Floor

- Restrooms
- Information
- Ticketing
- Elevator
- Escalator
- Stairs
- Emergency Exit
- Closed

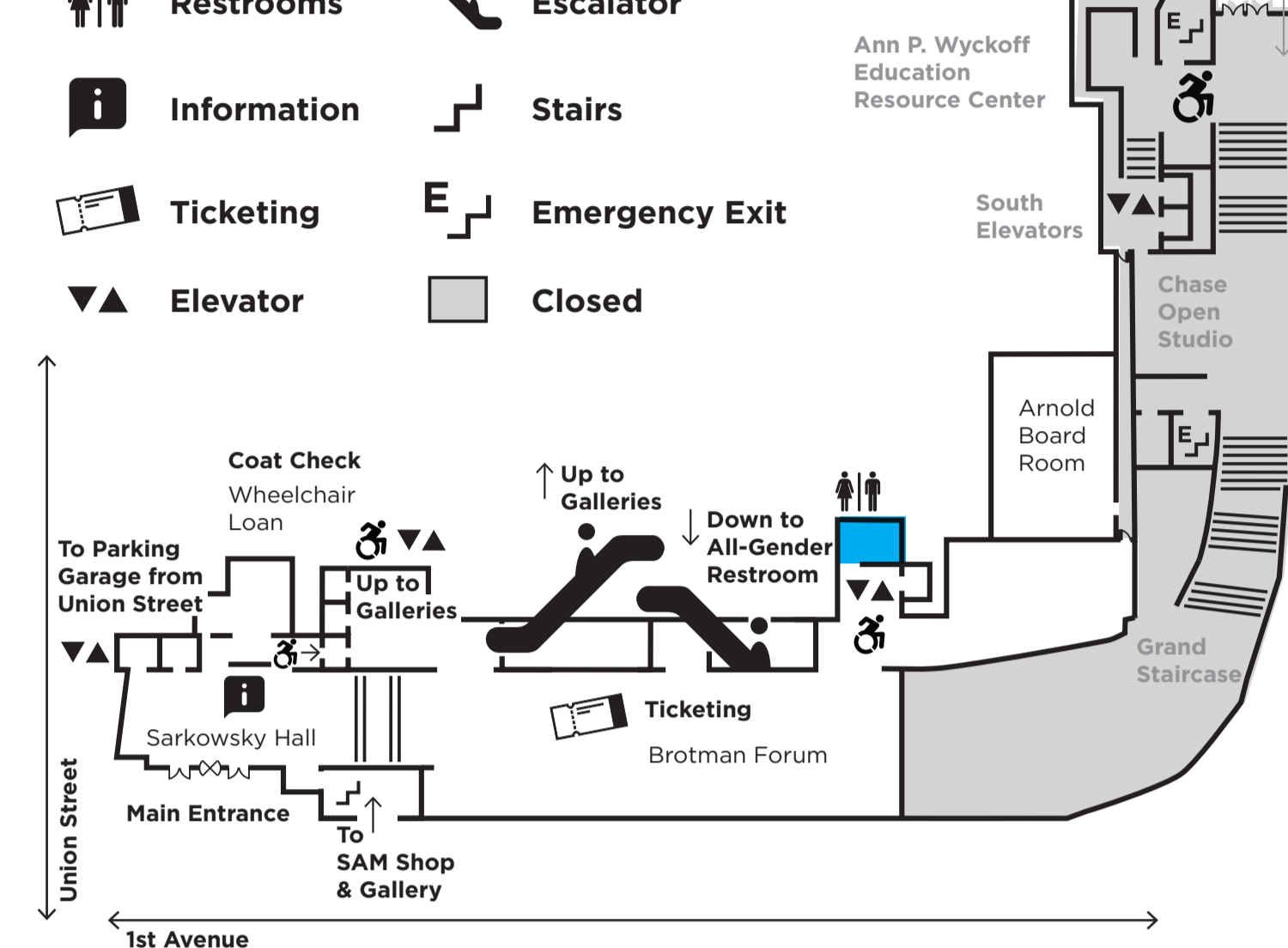

Smartphone Tour

Smartphone tours are available on your own device for free! Select a thematic tour or look for the phone symbol/QR code next to selected artworks and enter the number to access multimedia content and interesting perspectives.

visitsam.org/explore

Third Floor

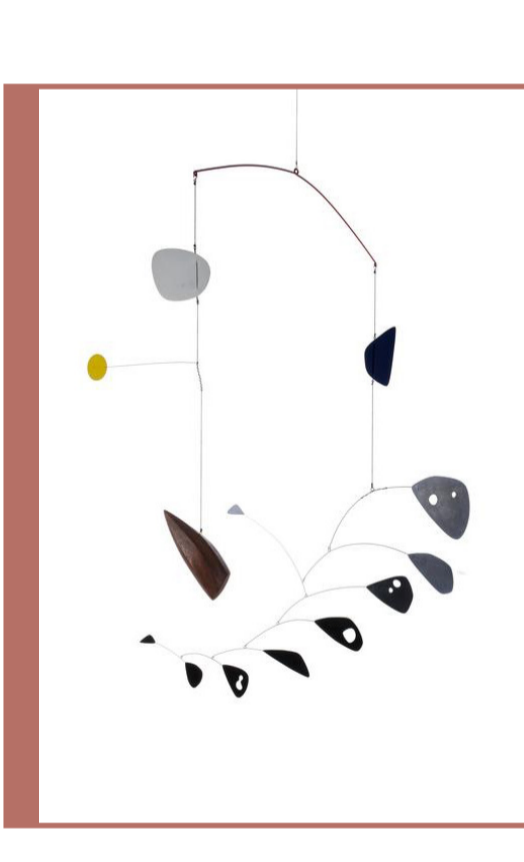
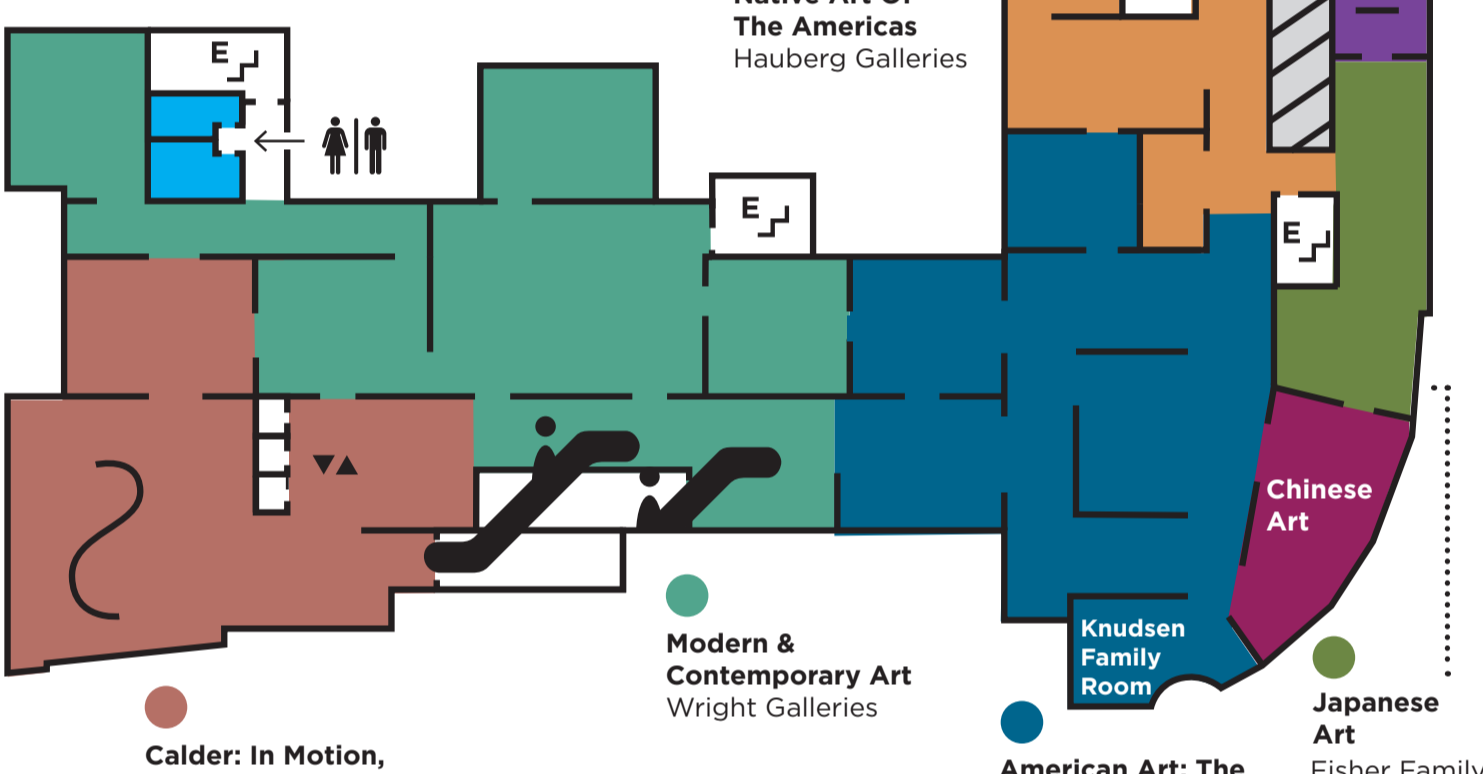

Calder: In Motion, The Shirley Family Collection
Nov 8 2023 - Aug 4 2024

Discover the iconic artist Alexander Calder, celebrated for revolutionizing sculpture with his renowned mobiles and stabiles. This is a rare opportunity to see the collection of over 45 works, plus lithographs and related ephemera, gifted to the museum by Jon and Kim Shirley, together for the first time.

Untitled, 1948, Alexander Calder



American Art: The Stories We Carry
Ongoing

Explore a more expansive vision of American art, with artworks from the museum's historical American collection presented in the museum's conversation with Native, Asian American, African American, and Latinx art.

Northwest Salmon Fishermen, 1941, Rudolph Franz Zallinger

Fourth Floor

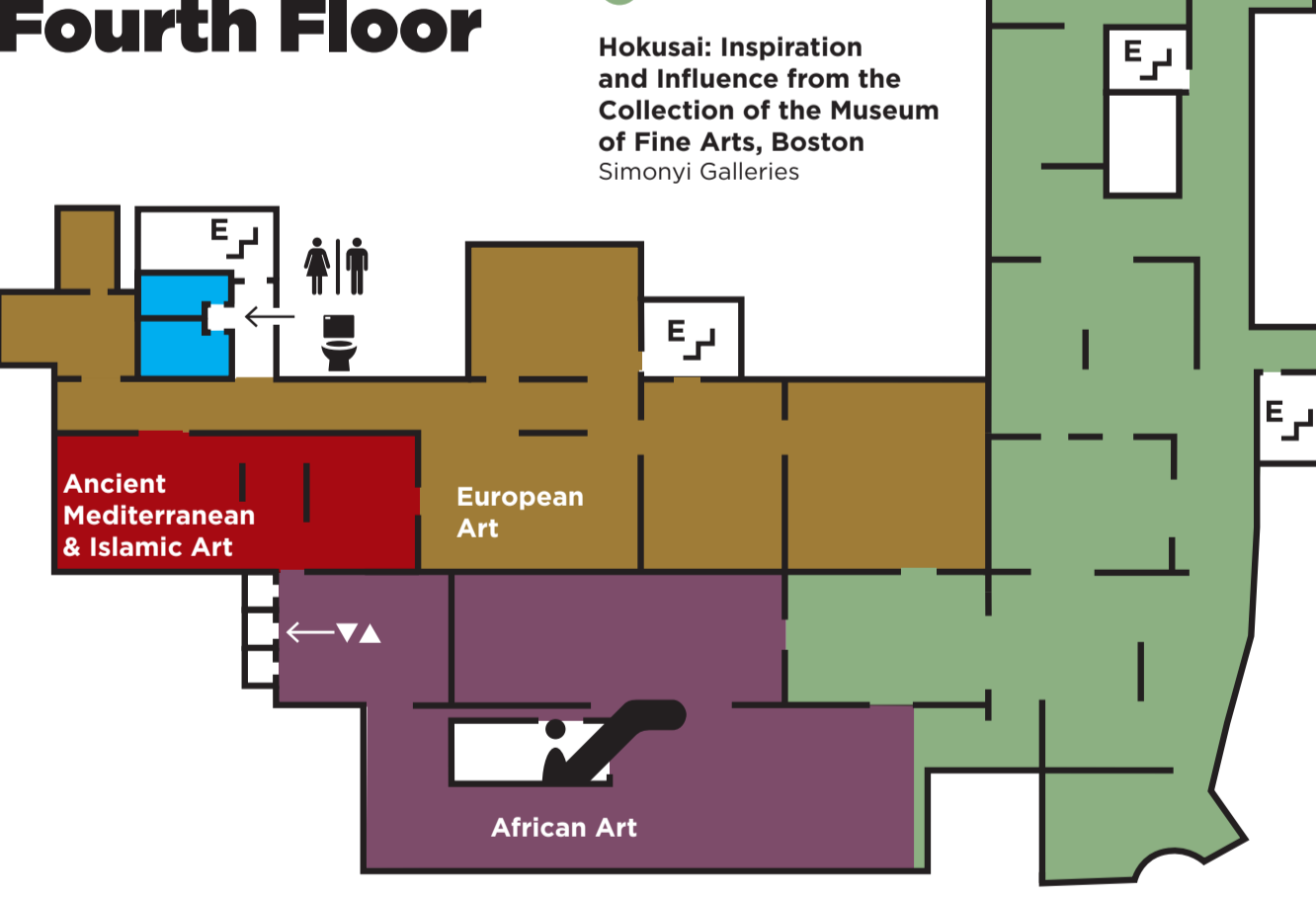

Hokusai: Inspiration and Influence from the Collection of the Museum of Fine Arts, Boston
Through Jan 21

You know the *Great Wave*, now get to know the artist behind the legendary work. This exhibition explores the enduring legacy of Katsushika Hokusai (1760-1849), pairing more than 100 of his woodblock prints and paintings with more than 200 works by his teachers, students, rivals, and admirers.

Under the Wave off Kanagawa (Kanagawa-oki nami-ura), also known as the *Great Wave*, 1830-31, Katsushika Hokusai

Turn your ticket into a membership today!

Become a SAM member and enjoy unlimited free admission all year. Visit the Ticketing Desk or give us a call at 206.654.3210 to apply your ticket towards a membership today!

Seattle Art Museum respectfully acknowledges that we are on Indigenous land, the traditional territories of the Coast Salish people. We honor our ongoing connection to these communities past, present, and future.

Images: *Untitled*, ca. 1948, Alexander Calder, 1898-1976, sheet metal, wire, wood, string, and paint, 52 x 95 x 3 in., Promised gift of Jon and Mary Shirley, © 2023 Calder Foundation, New York / Artists Rights Society (ARS), New York, photo: Nicholas Shirley, Brightwood Photos. *Northwest Salmon Fishermen*, 1941, Rudolph Franz Zallinger, tempera on pressed fiber board, in artist-made engaged frame, 25 3/4 x 35 5/8 in., in artist made engaged frame, 27 7/8 x 37 7/8 in., Eugene Fuller Memorial Collection, 43.34, © Rudolph F. Zallinger. Image courtesy of the artist. *Under the Wave off Kanagawa* (Kanagawa-oki nami-ura), also known as the *Great Wave*, from the series *Thirty-six Views of Mount Fuji* (Fugaku sanjūrokkei), about 1830-31 (Tenpō 1-2), Katsushika Hokusai, Japanese, 1760-1849, woodblock print (nishiki-e); ink and color on paper, Museum of Fine Arts, Boston, William Sturgis Bigelow Collection, Photograph © Museum of Fine Arts, Boston.